

ASSEMBLY INSTRUCTIONS

Questions?

GIVE US A CALL: 1-888-980-5122
MON – FRI 8:30AM – 5:30PM (PST)

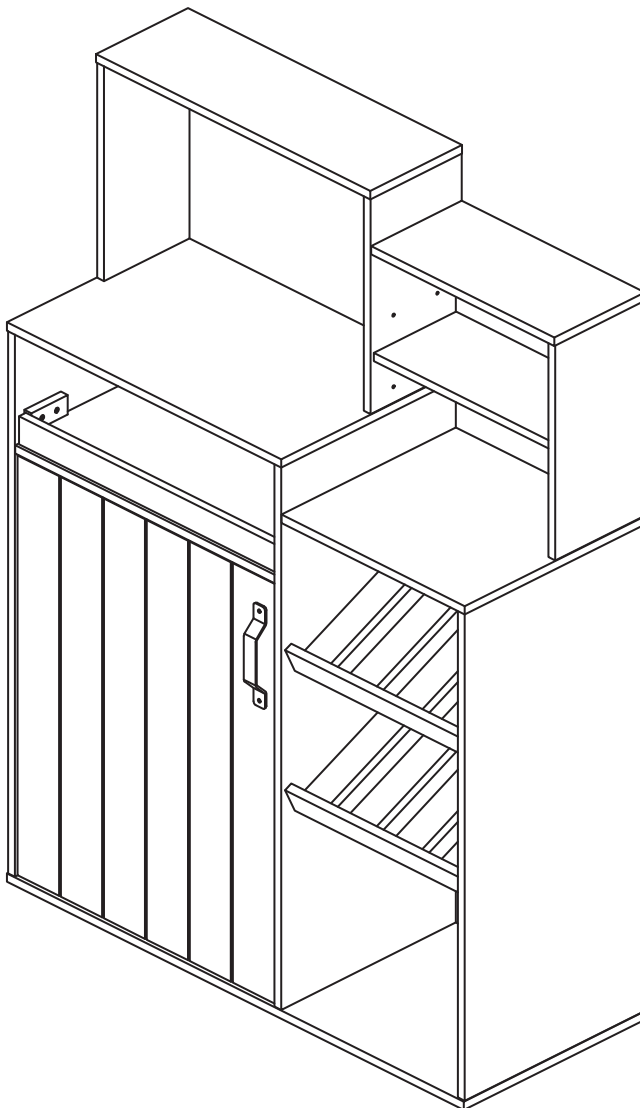

TOOLS REQUIRED



Hammer

(Not Included)



Philips Screwdriver

(Not Included)



**2 - People
Recommended**

ASSEMBLY RATING



EASY —————> DIFFICULT

The Assembly Rating is a 5-point system showing the level of effort needed to assemble a specific product.



Thank you for your purchase!

We hope you enjoy this new addition to your home for many years to come.

Our commitment to providing quality products does not simply end when you purchase our product. We fully stand behind our products from start to finish. Our customer service department is available Monday – Friday 8:30 AM – 5:30 PM Pacific and can help with assembly questions as well as, if necessary, replacing damaged or missing parts. To help expedite our service, please have these assembly instructions readily available, along with your order receipt.



Consumer Hotline
Toll-Free 1-888-980-5122



Monday to Friday
8:30AM- 5:30PM (PST)



WEBSITE
www.foagroup.com



E-MAIL
cs.ec@foagroup.com



foagroup



FurnitureOfAmerica



CHECK BEFORE STARTING

☐

Are you missing anything?

Double-check all parts, hardware and accessories listed are all accounted for.

☐

Check out our Quick Tips!

We recommend reviewing the pre-assembly handouts. Even experts need a refresher now and then!

☐

Should we send any replacements?

Are there any irregularities or flaws in the parts? We can send replacements!

☐

Prep Time!

Please review the assembly instructions and all diagrams prior to assembling. Arrange parts as recommended on Page 7 and group identical hardware together to make assembling easier.

PRE ASSEMBLY INTRODUCTION

We understand building ready-to-assemble furniture can be a challenging experience for some. To help avoid confusion, we have provided some helpful tips that may speed up the process.

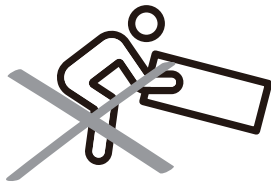

Teamwork

ALWAYS have at least two people to help with transporting and assembling the product to avoid potential injury and/or damage.

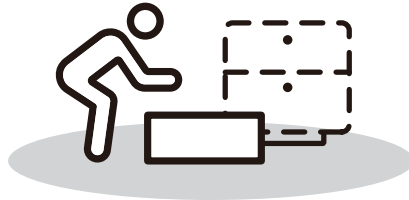
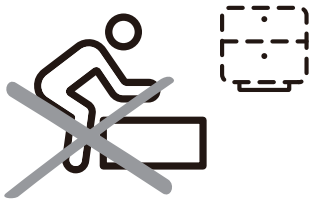

Suitable Location

Assembling near the area of the intended location is highly recommended.



Sufficient Space

Make sure you have enough space to move around during the assembly.



Avoid Scratches

Use cardboard, blankets or a carpeted area while assembling furniture to prevent scratches.

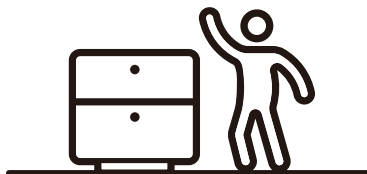
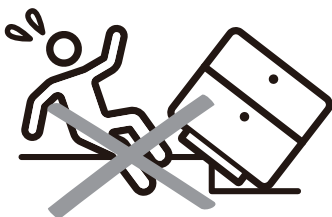

Flat Surface

Make sure the furniture rests on a flat and level surface with each leg evenly touching the floor.

ASSEMBLY AND CARE ADVICE



**FAILURE TO FOLLOW THE GUIDELINES BELOW MAY
RESULT IN INJURY AND/OR PROPERTY DAMAGE.**



Position each part correctly
and insert screws or bolts into
their respective holes.

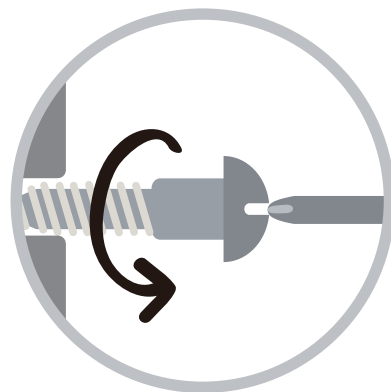

Turn clockwise to tighten and
only tighten when step is
completed or when instructed
to do so.



Save the instructions and store
any supplied tools for later
maintenance.

Use the appropriate hand tools
or power tools for assembly.
Select steps, such as tightening
screws and/or bolts, may require
hand tools to avoid causing
damage during assembly.

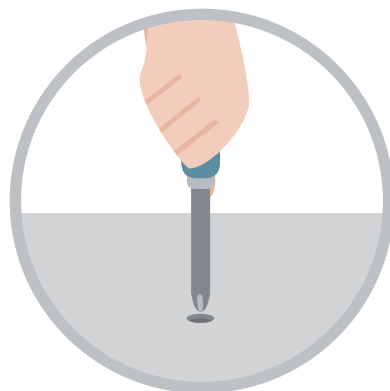

After two weeks, check and
tighten any loose hardware and
repeat again every six months
thereafter.

IT IS THE USER'S RESPONSIBILITY TO MAINTAIN THE FURNITURE. THE HARDWARE MAY LOOSEN OVER TIME AND MAY CAUSE THE FURNITURE TO BE WOBBLY AND UNABLE TO SUPPORT ITS INTENDED WEIGHT CAPACITY. THIS MAY LEAD TO COLLAPSE AND MAY CAUSE SERIOUS INJURY.

CAM LOCK FASTENER ASSEMBLY INSTRUCTIONS

Note :

Every cam lock bolt must have a cam lock connector in order to fasten the parts together.

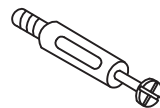

cam bolt



cam lock

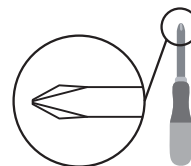

screwdriver

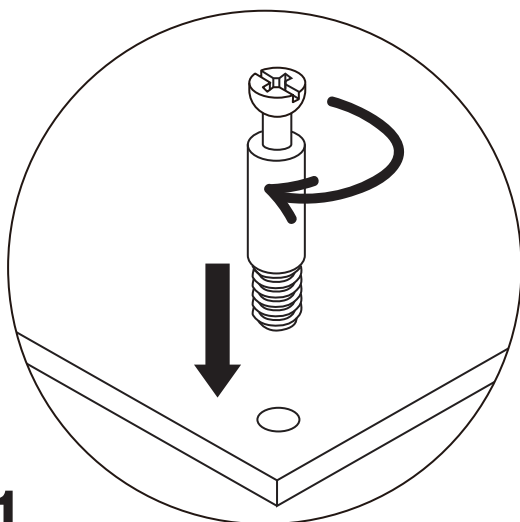

1

Screw the cam bolt into panel.

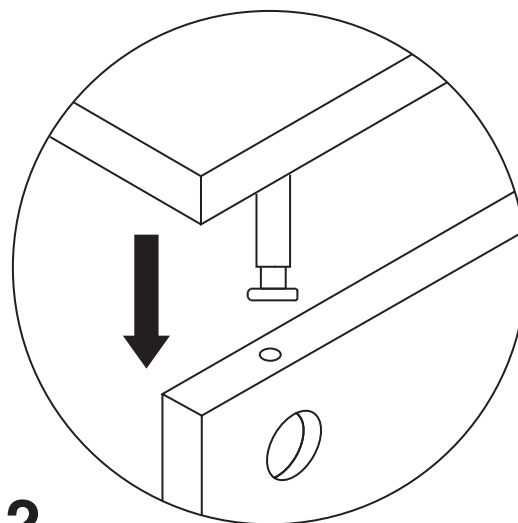

2

Insert the cam bolt into the bolt hole of joint panel.

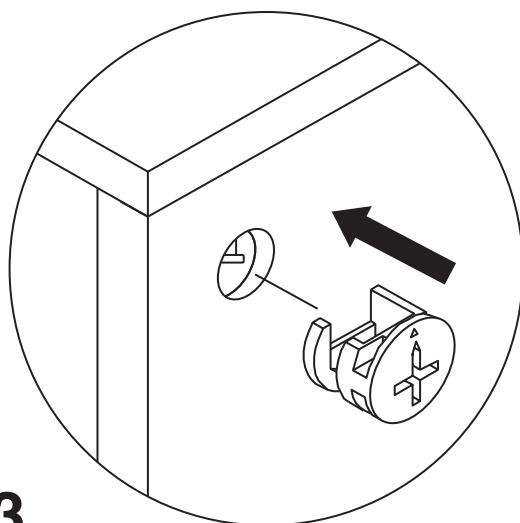

3

Align the cam lock with its side opening (or arrow) pointing to cam bolt.

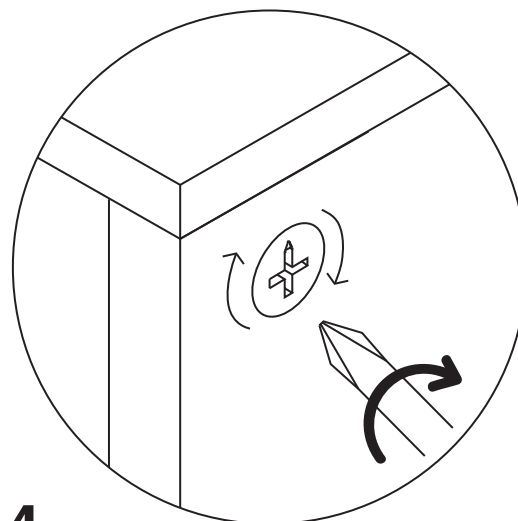

4

Turn the cam lock clockwise gently until it will not turn any more.

BUFFET

FGI-17703C21

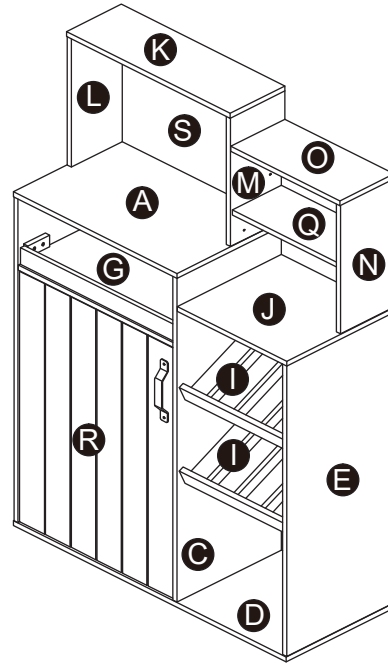
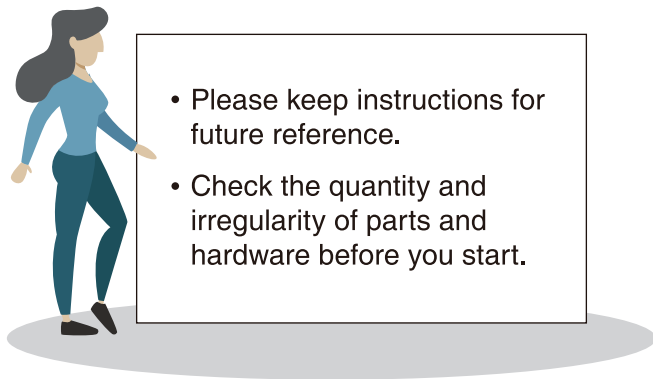

PARTS

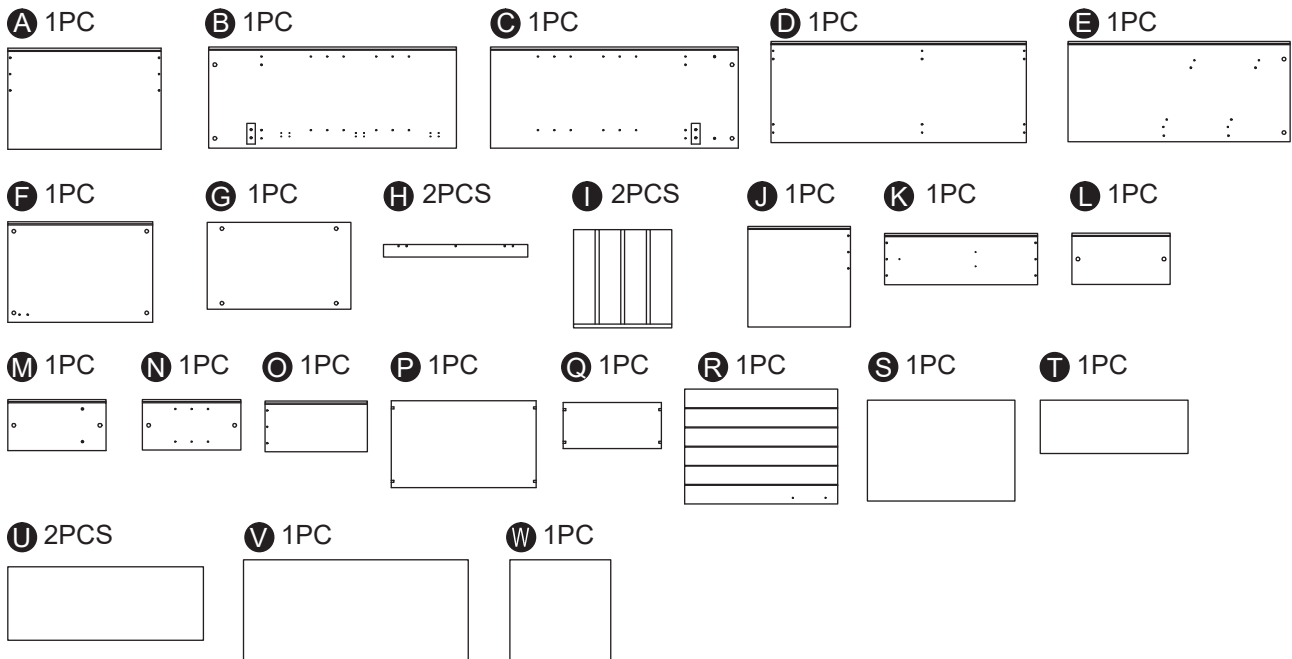

HARDWARE

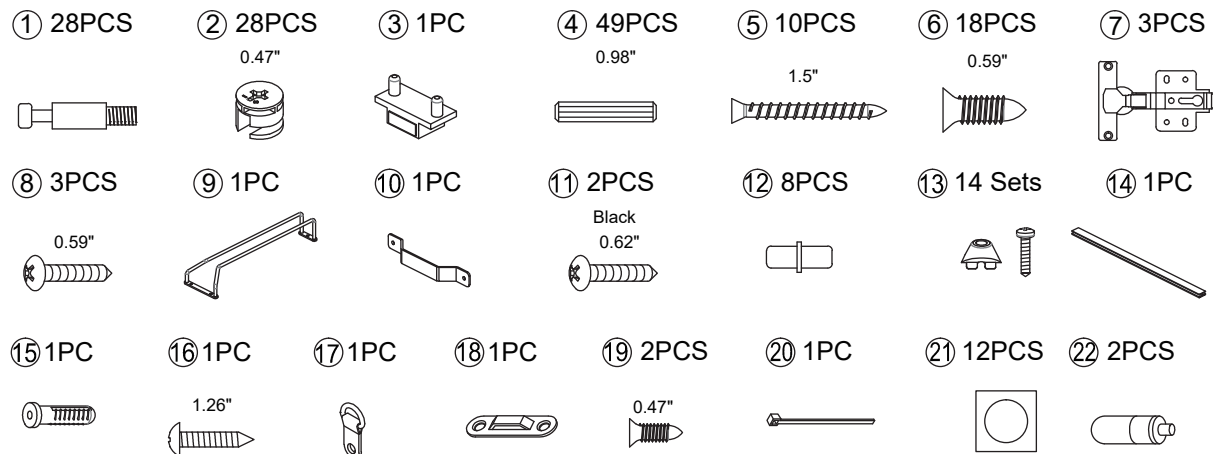

GET READY

Please group boards as below.

B 1PC



F 1PC



G 1PC



H 2PCS

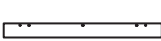

C 1PC



T 1PC

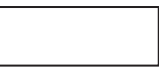

A 1PC



E 1PC

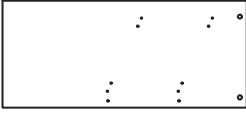

J 1PC



I 2PCS

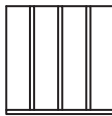

U 2PCS



V 1PC



D 1PC

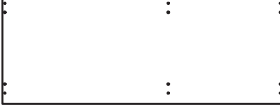

W 1PC



O 1PC

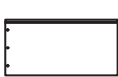

N 1PC

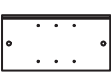

M 1PC

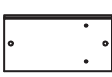

L 1PC



S 1PC

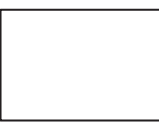

K 1PC

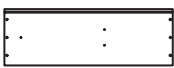

P 1PC



Q 1PC



Body

R 1PC

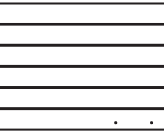

Doors

ASSEMBLY INSTRUCTIONS

STEP : 1

Hardware ① x 22PCS

Hardware ③ x 1PC

Hardware ④ x 34PCS

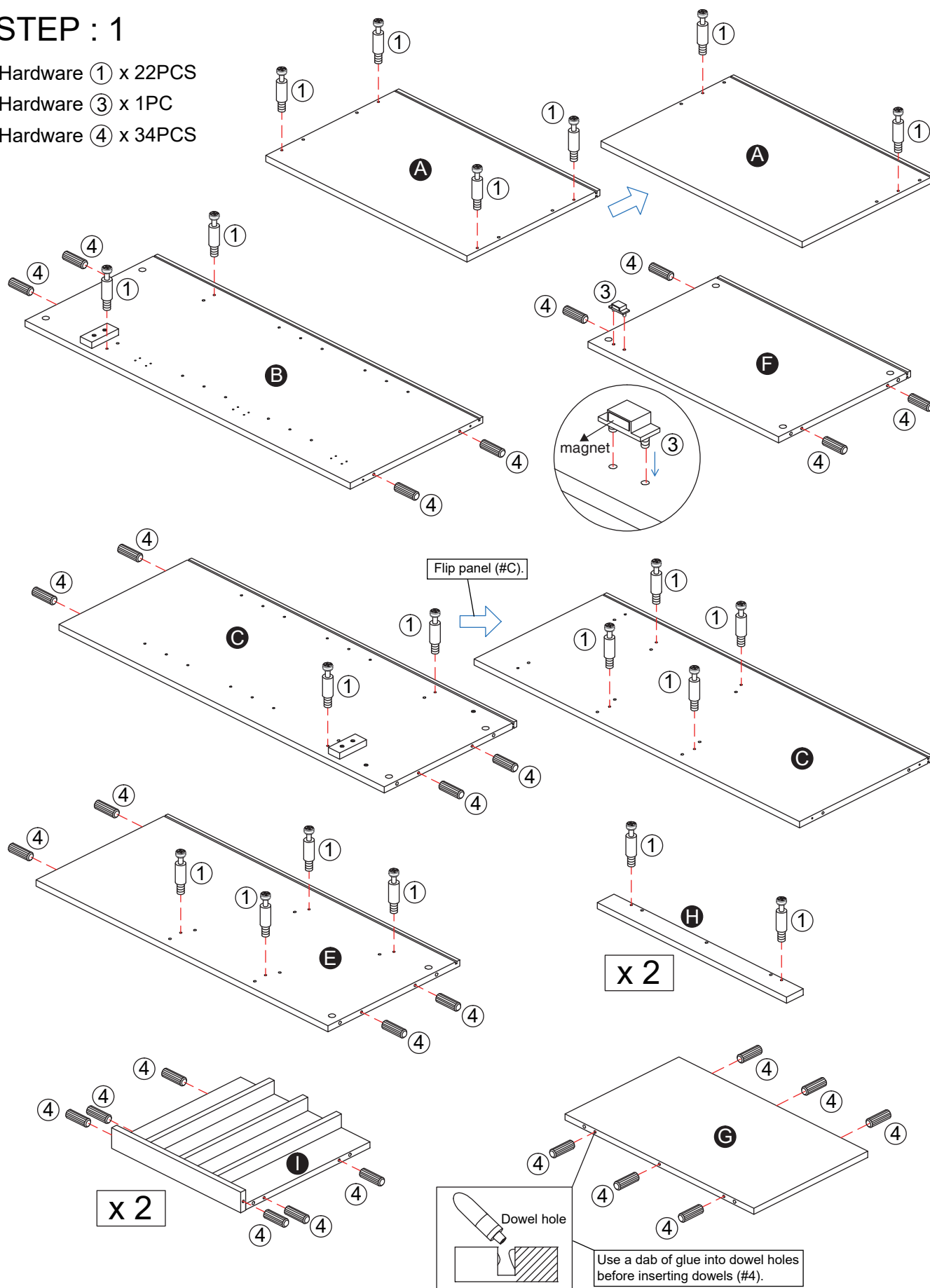

ASSEMBLY INSTRUCTIONS

STEP : 2

Hardware ① x 6PCS

Hardware ④ x 15PCS

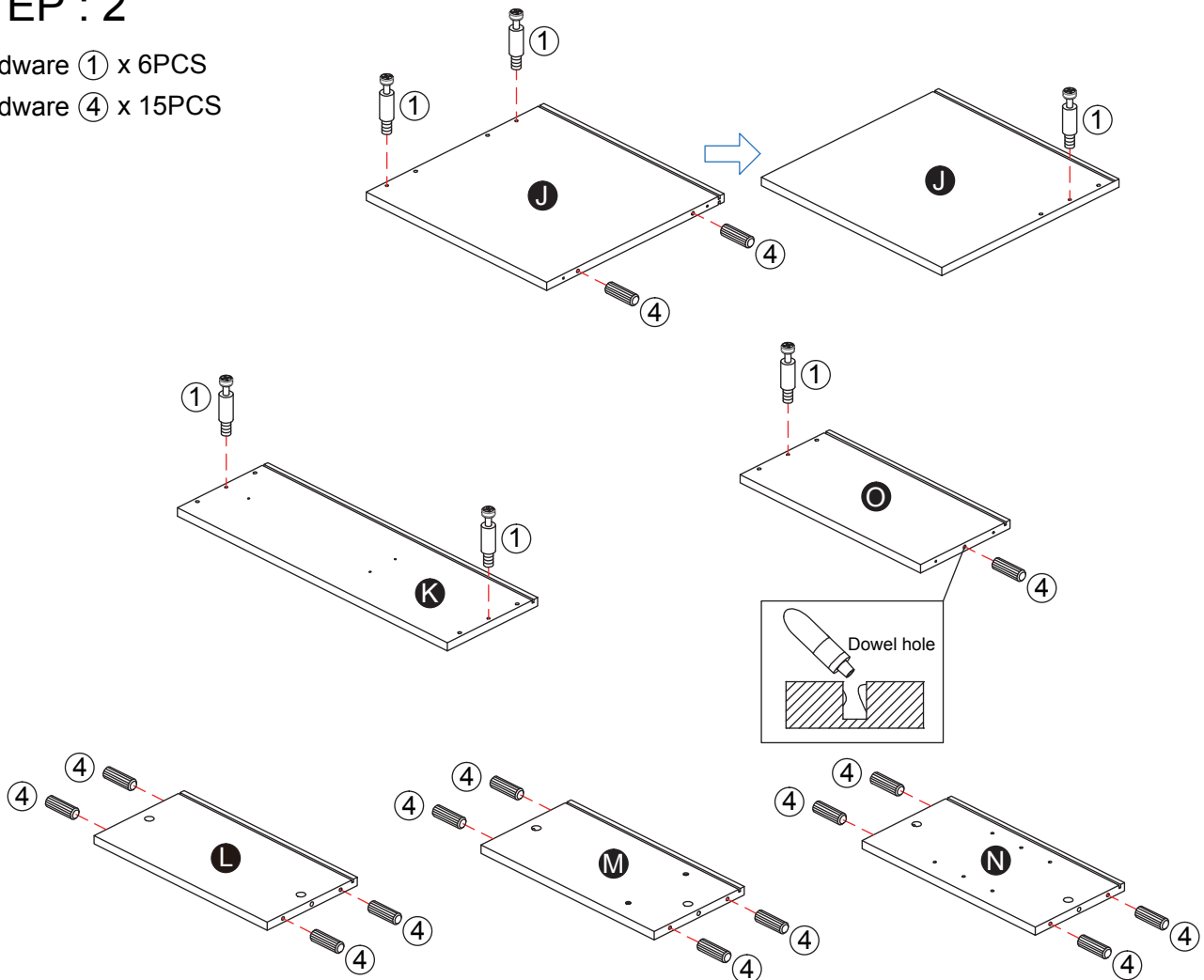

STEP : 3

Hardware ⑥ x 6PCS

Hardware ⑦ x 3PCS

Hardware ⑩ x 1PC

Hardware ⑪ x 2PCS

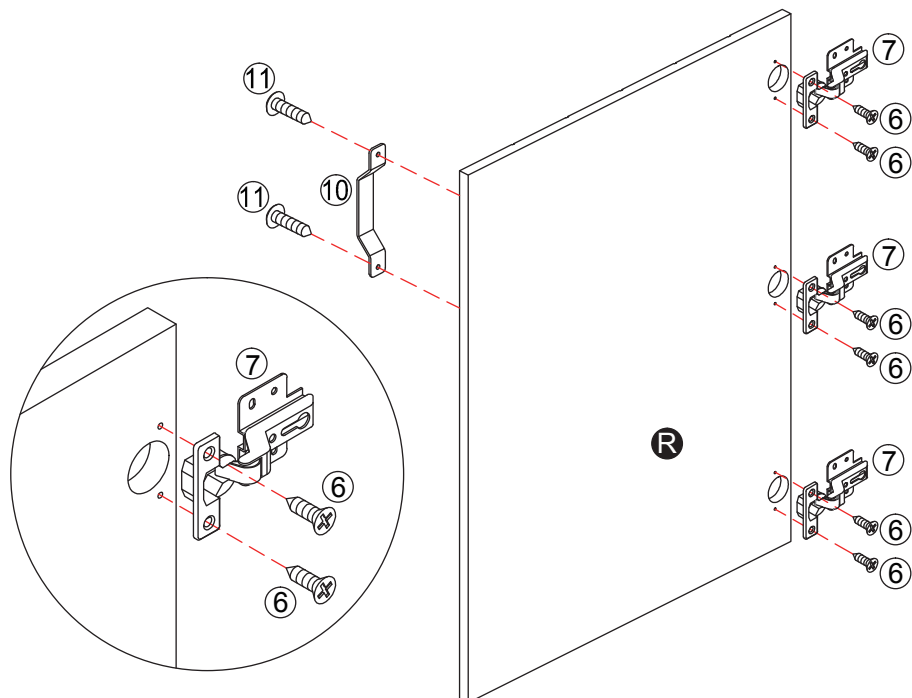

ASSEMBLY INSTRUCTIONS

STEP : 4

Hardware ② x 2PCS

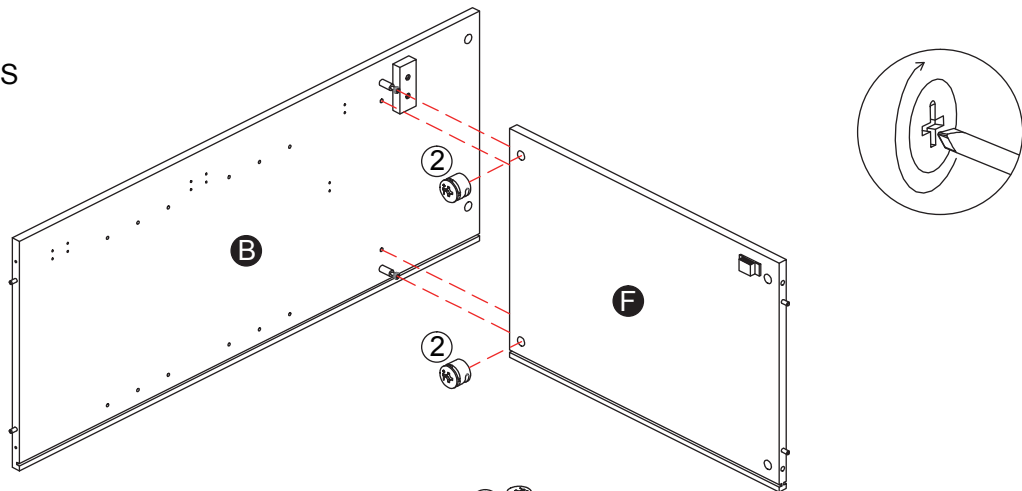

STEP : 5

Hardware ② x 4PCS

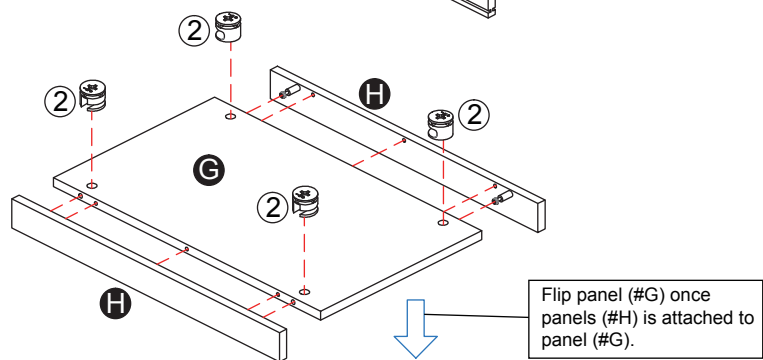

STEP : 6

Hardware ② x 2PCS

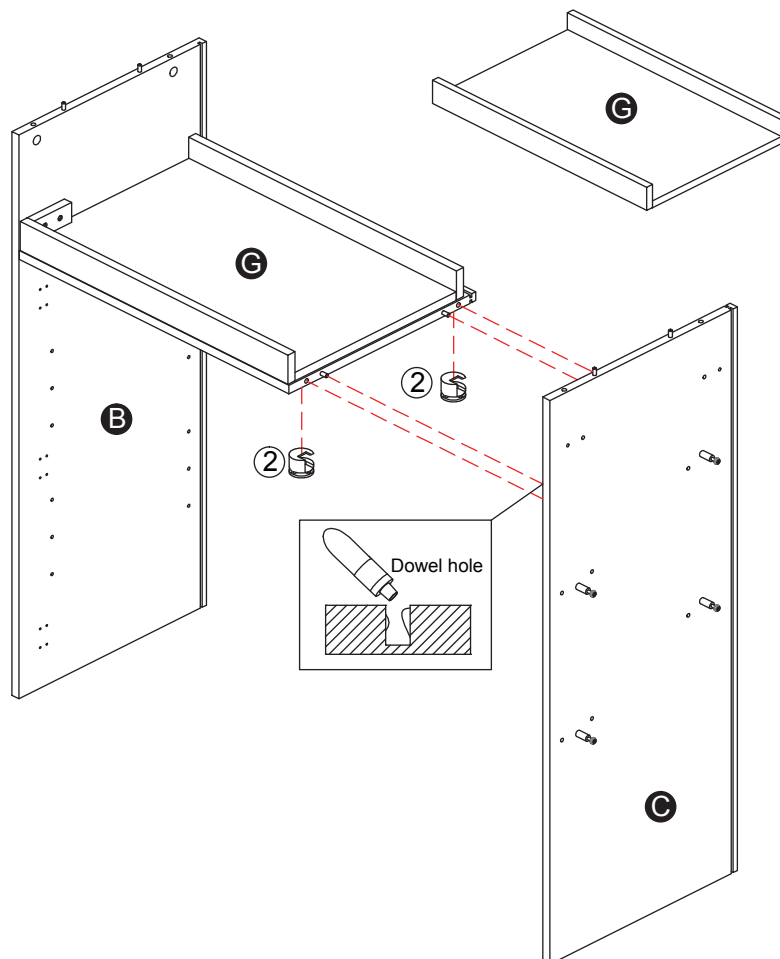

ASSEMBLY INSTRUCTIONS

STEP : 7

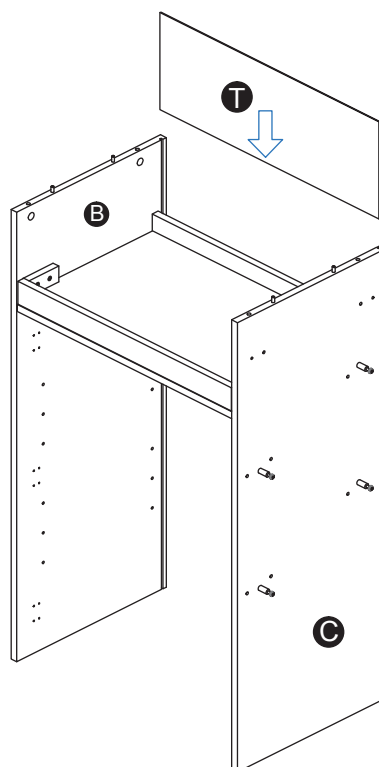

STEP : 8

Hardware ② x 4PCS

Hardware ②① x 4PCS

Use stickers (#21) to cover cam locks (#2) in this step.

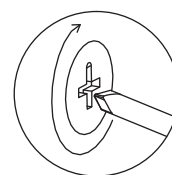
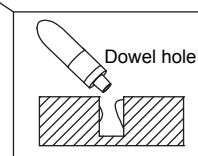
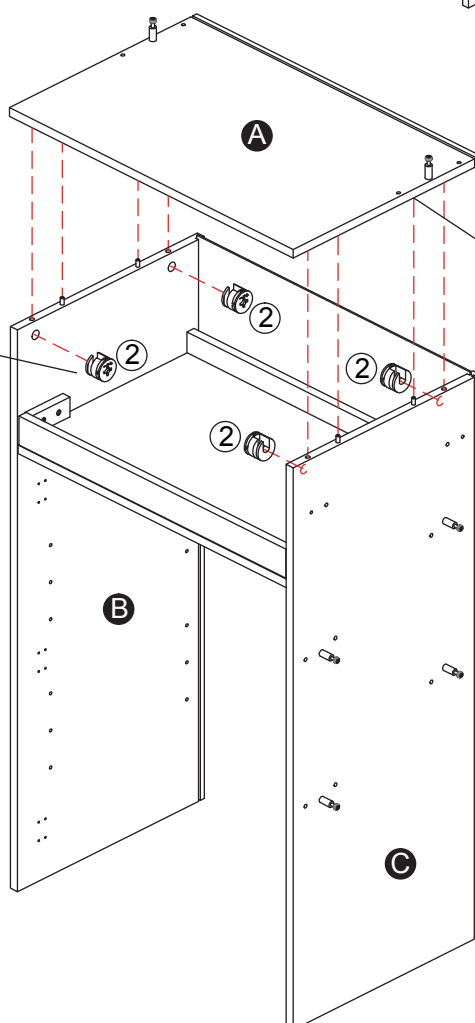
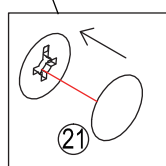

ASSEMBLY INSTRUCTIONS

STEP : 9

Hardware ② x 2PCS

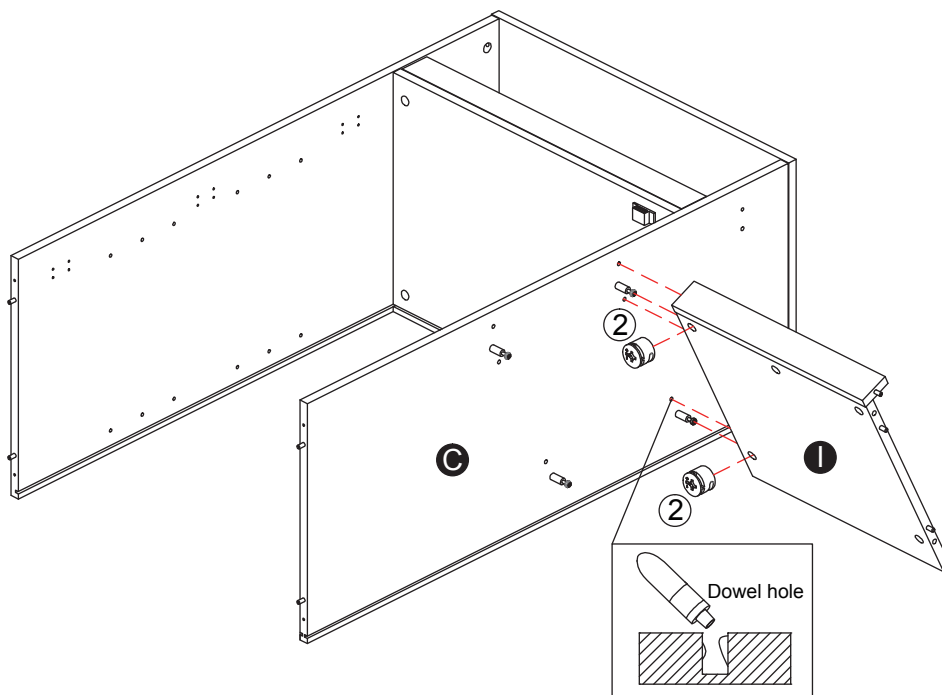

STEP : 10

Hardware ② x 2PCS

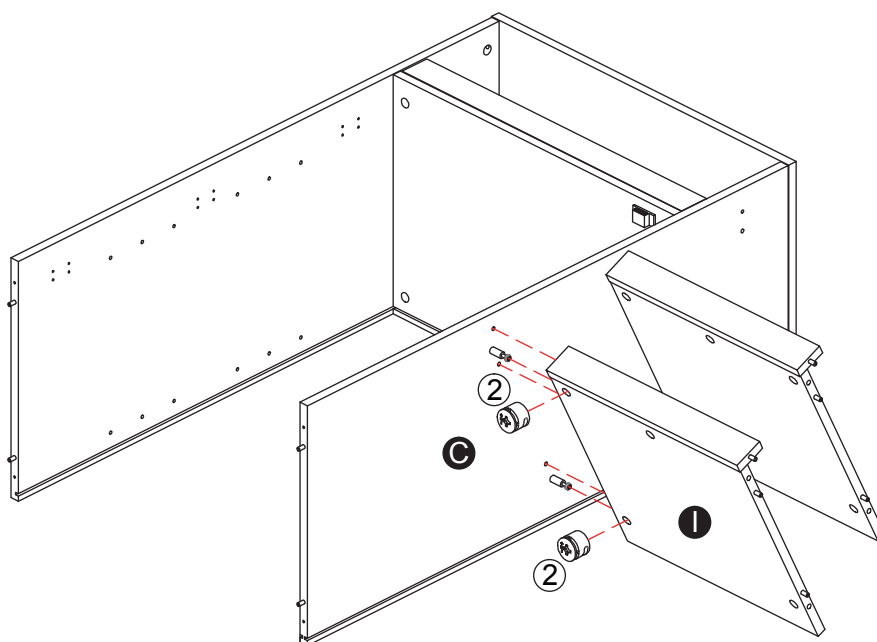
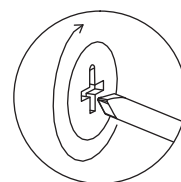

ASSEMBLY INSTRUCTIONS

STEP : 11

Hardware ② x 2PCS

Hardware ②① x 2PCS

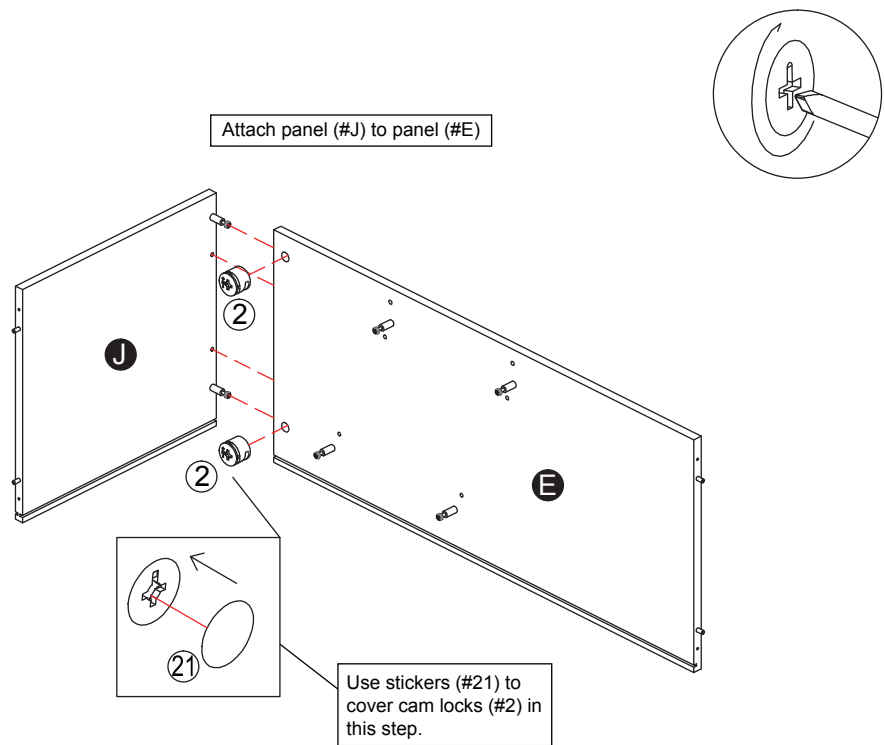

STEP : 12

Hardware ② x 4PCS

Hardware ⑤ x 2PCS

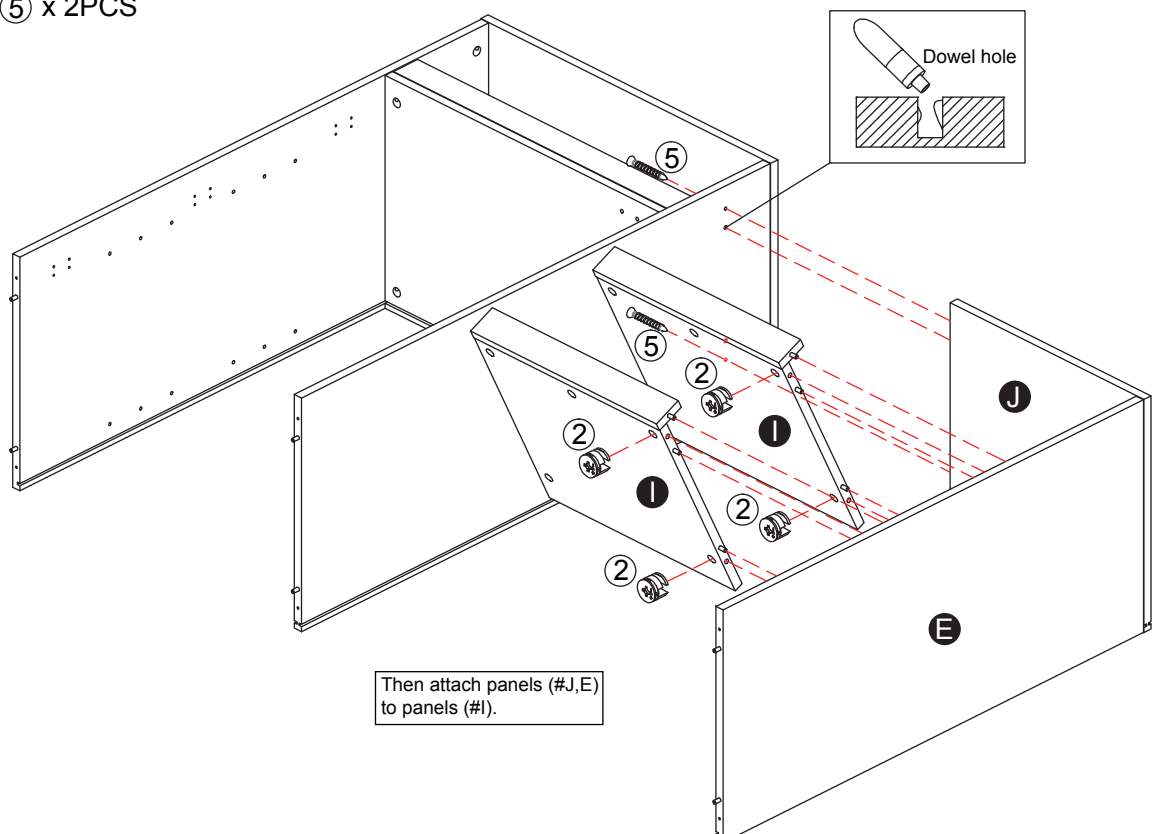

ASSEMBLY INSTRUCTIONS

STEP : 13

Hardware ⑭ x 1PC

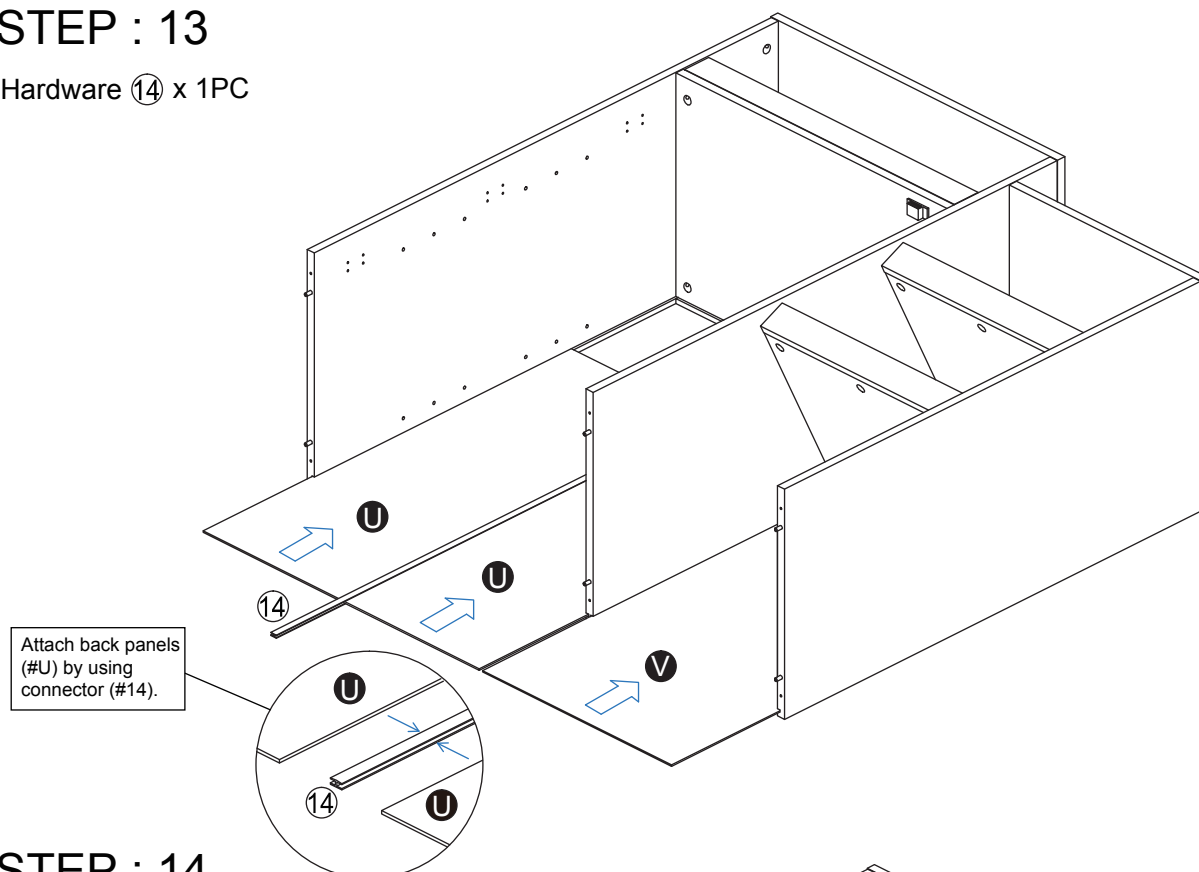

STEP : 14

Hardware ⑤ x 6PCS

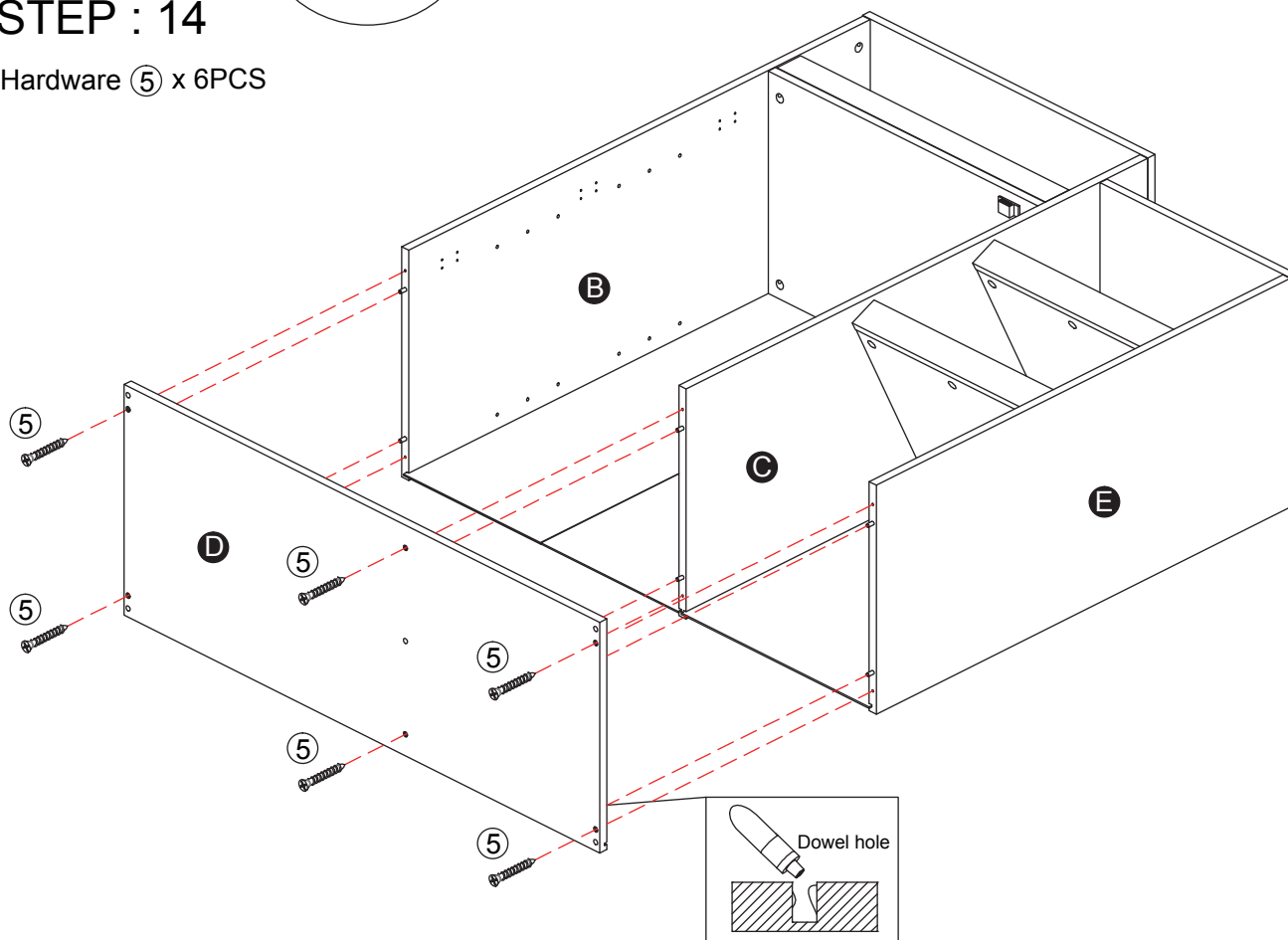

ASSEMBLY INSTRUCTIONS

STEP : 15

Hardware ② x 1PC

Hardware ⑤ x 2PCS

Hardware ②① x 1PC

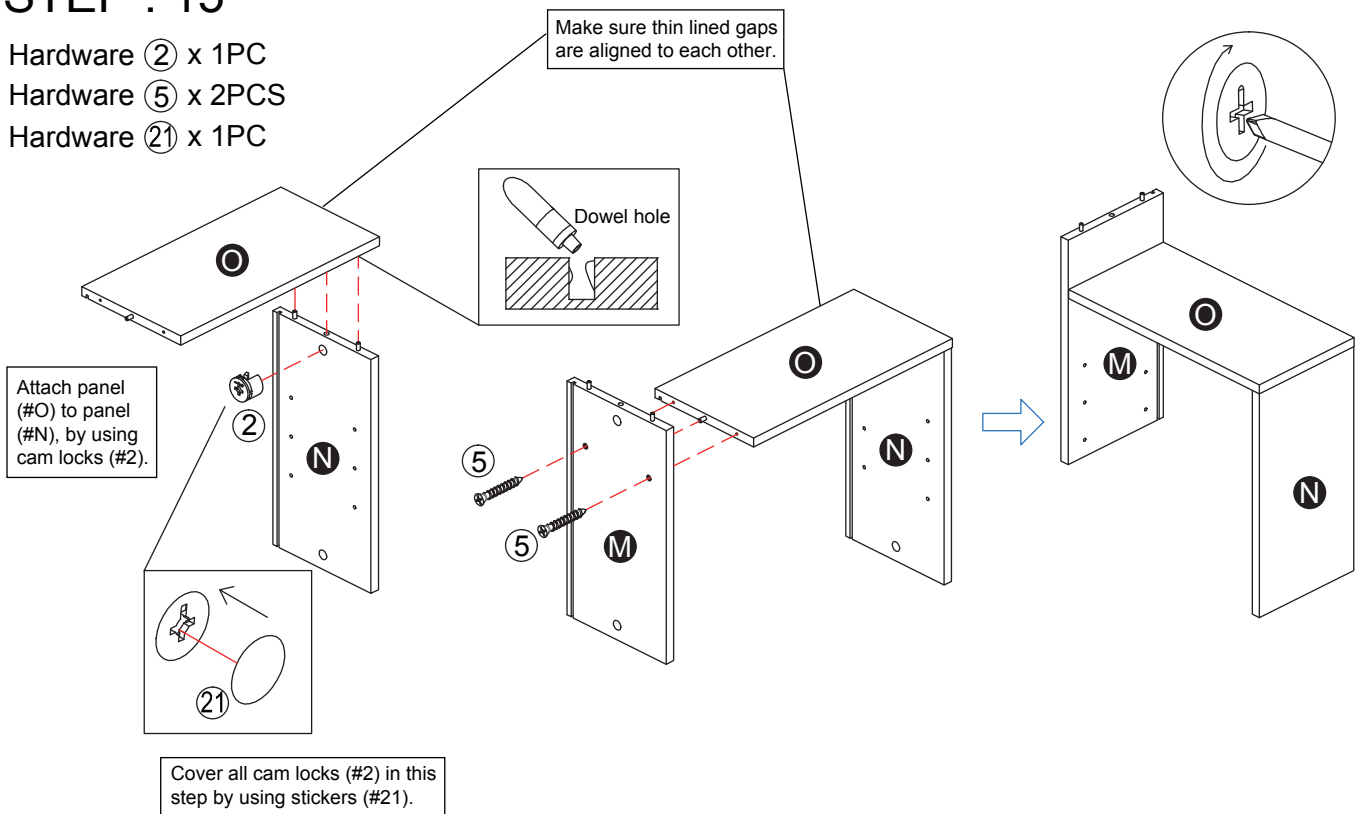

STEP : 16

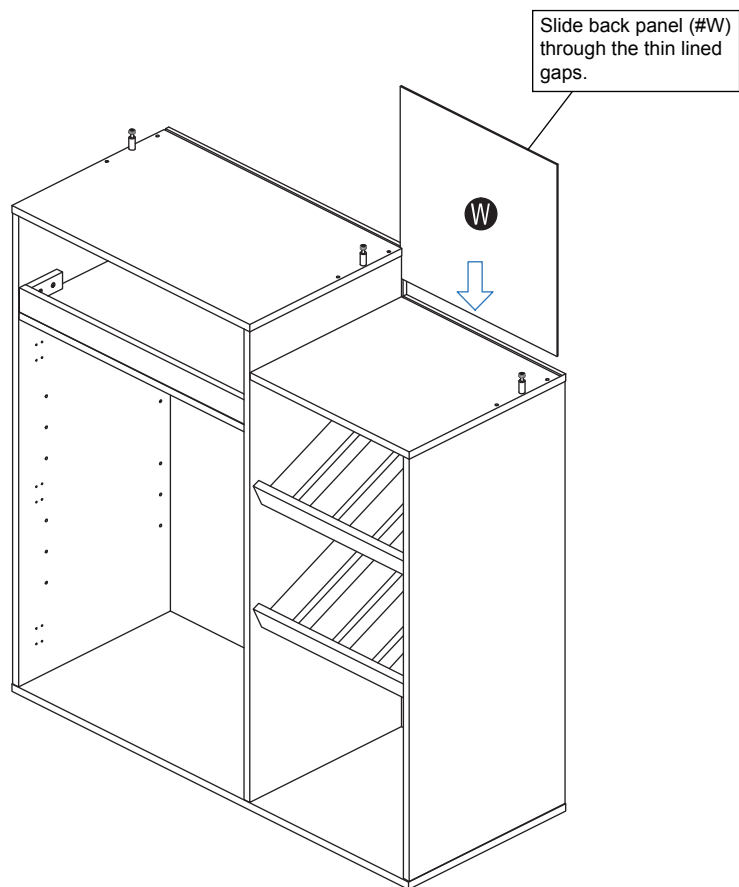

ASSEMBLY INSTRUCTIONS

STEP : 17

Hardware ② x 2PCS

Hardware ②① x 2PCS

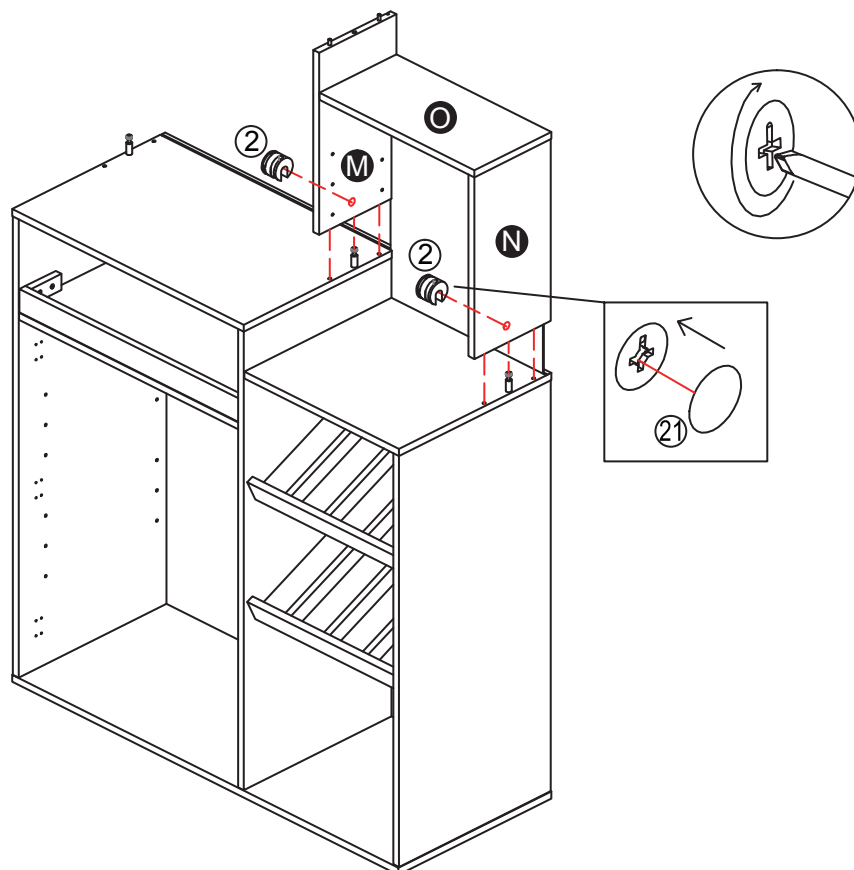

STEP : 18

Hardware ② x 1PC

Hardware ②① x 1PC

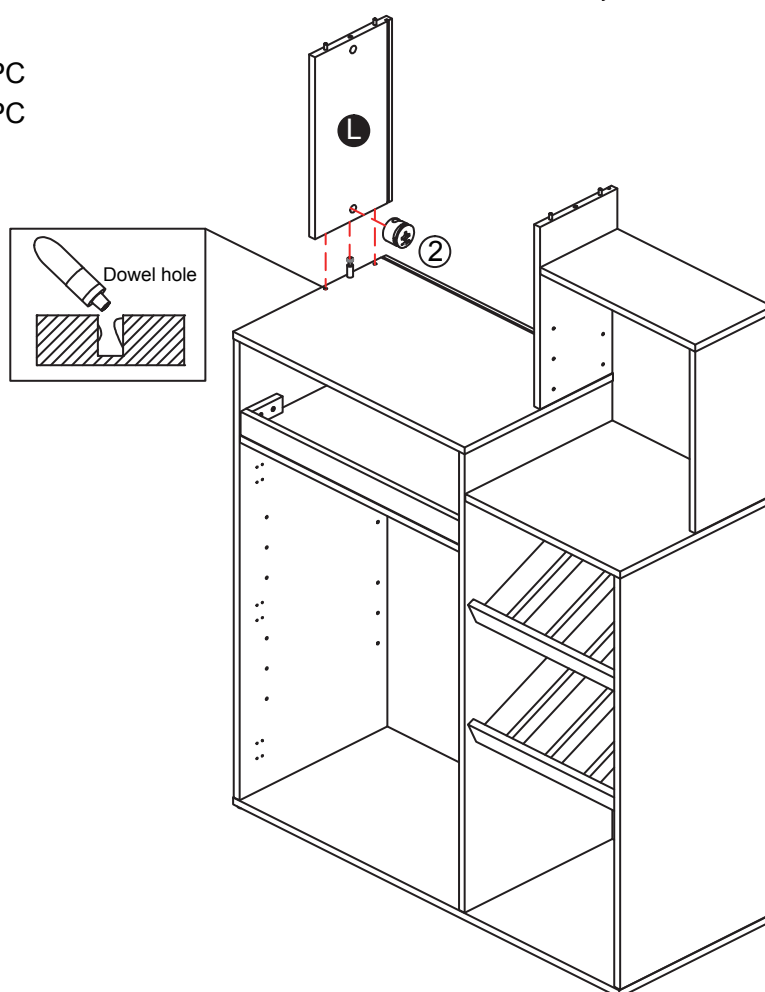

ASSEMBLY INSTRUCTIONS

STEP : 19

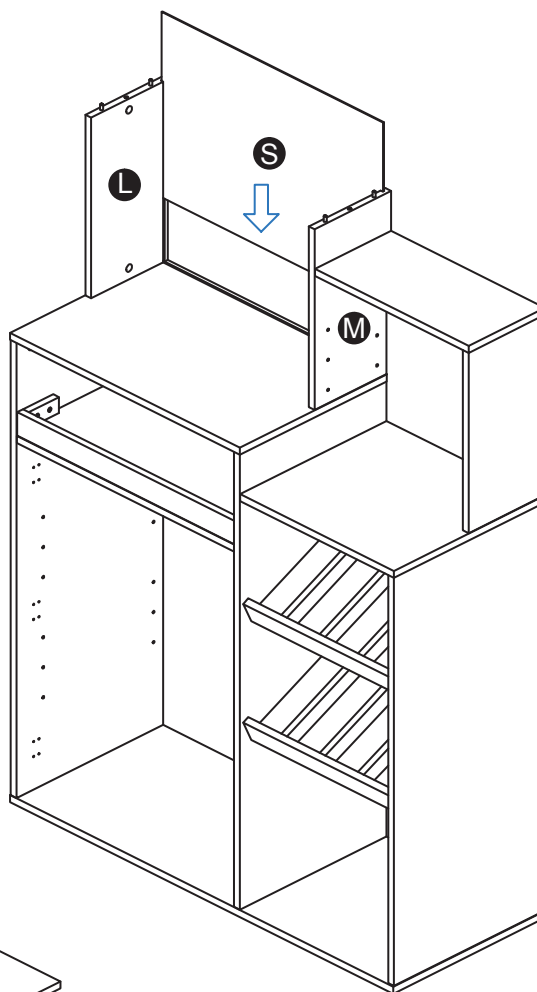

STEP : 20

Hardware ② x 2PCS

Hardware ②① x 2PCS

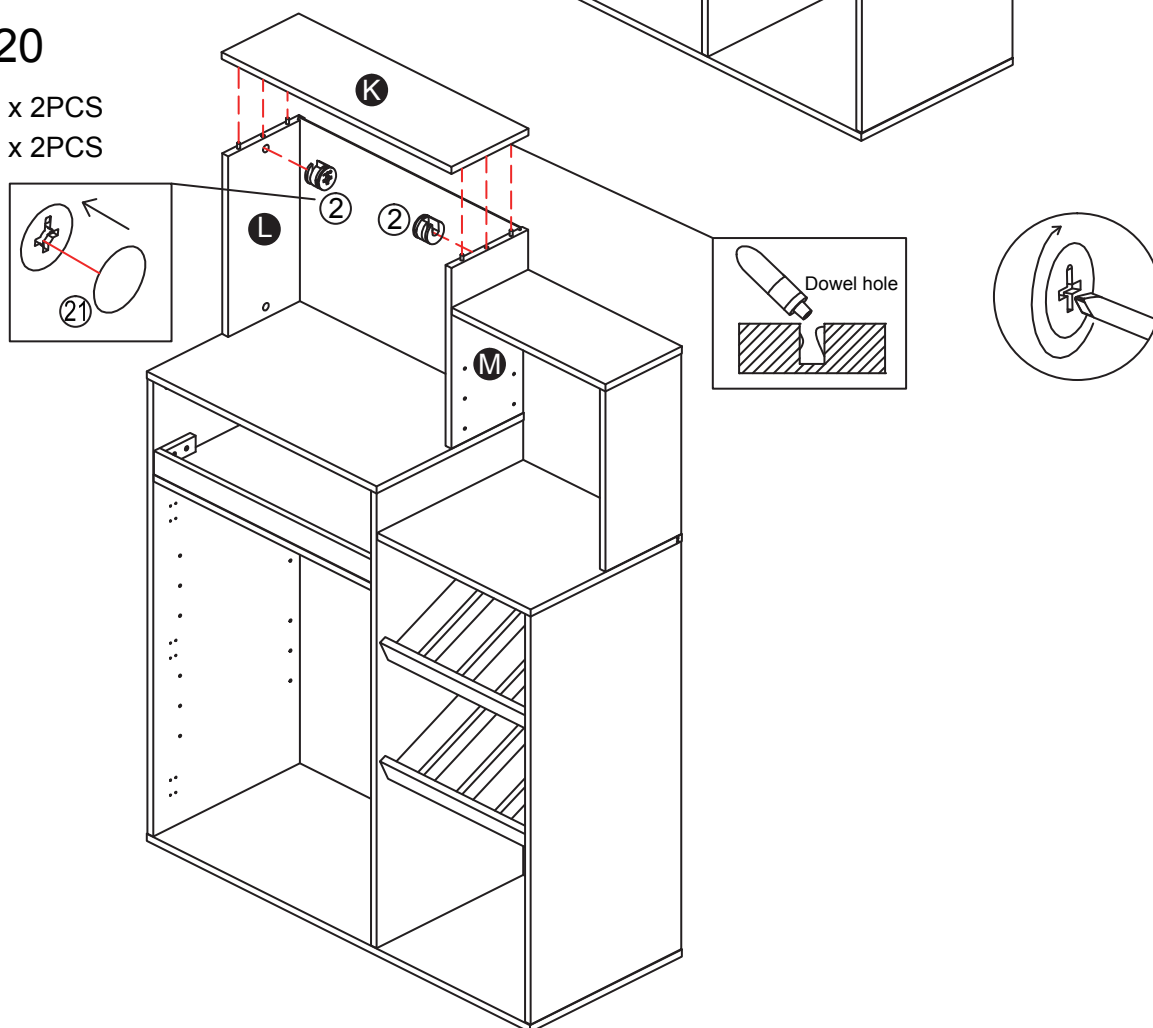

ASSEMBLY INSTRUCTIONS

STEP : 21

Hardware ⑧ x 3PCS

Hardware ⑨ x 1PC

Hardware ⑫ x 8PCS

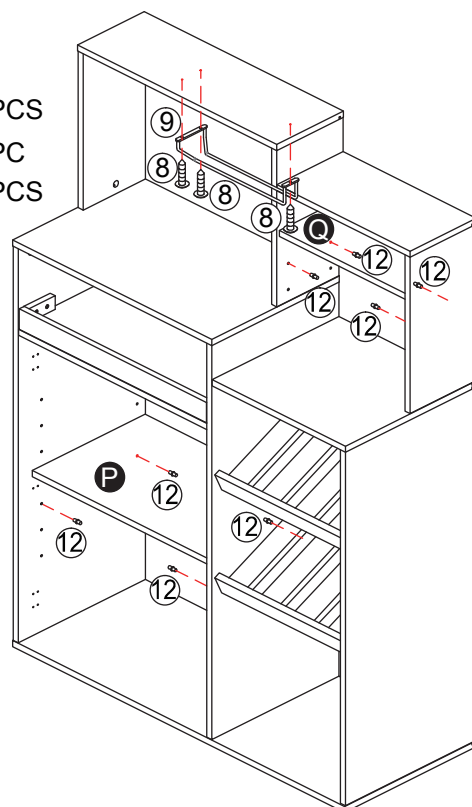

Insert shelf pins (#12) to the desired height of the shelves (#P,Q).

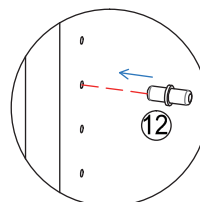

STEP : 22

Hardware ⑥ x 12PCS

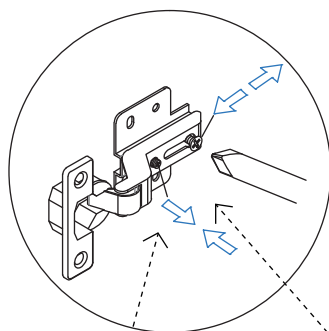
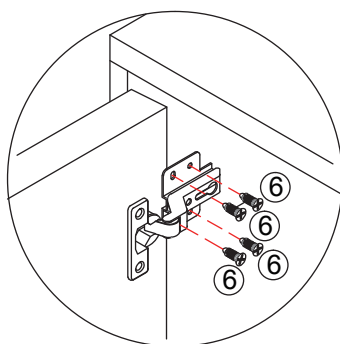

Screw this screw to adjust the depth of the hinges

Screw this screw to adjust the length of the hinges.

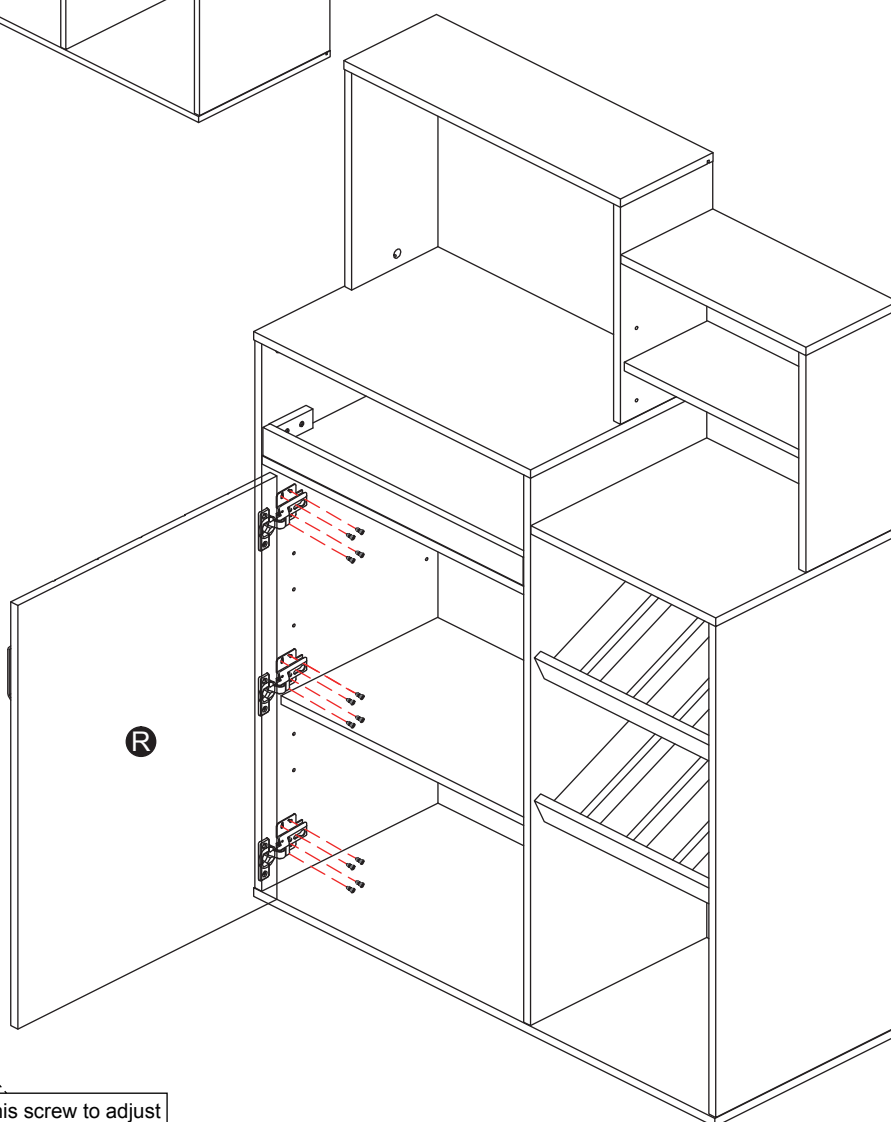

ASSEMBLY INSTRUCTIONS

STEP : 23

Hardware ⑬ x 14 Sets

Insert fixative plates (#13) through the thin lined gaps of the back panels, then secure by using screws (#13).

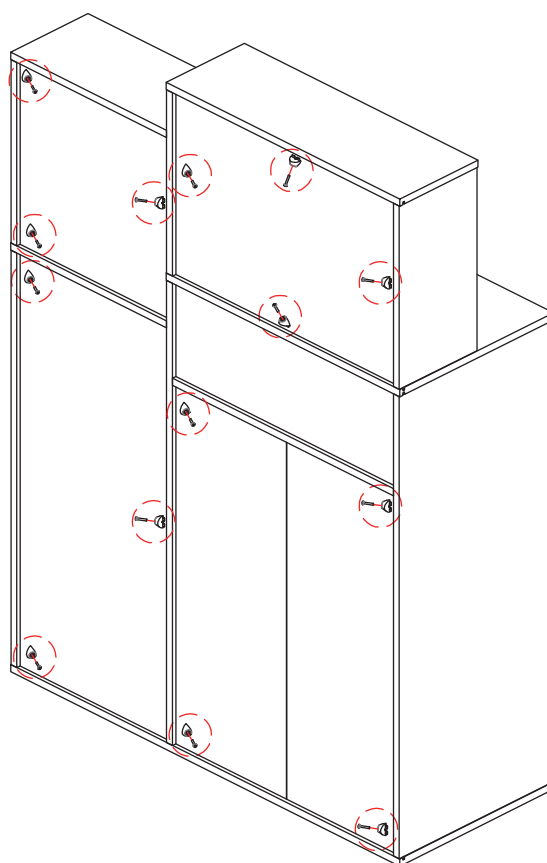
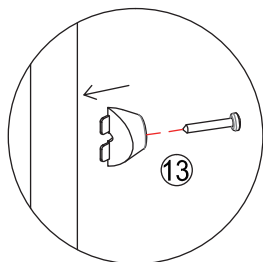

STEP : 24

Hardware ⑮ x 1PC

Hardware ⑯ x 1PC

Hardware ⑰ x 1PC

Hardware ⑱ x 1PC

Hardware ⑲ x 2PCS

Hardware ⑳ x 1PC

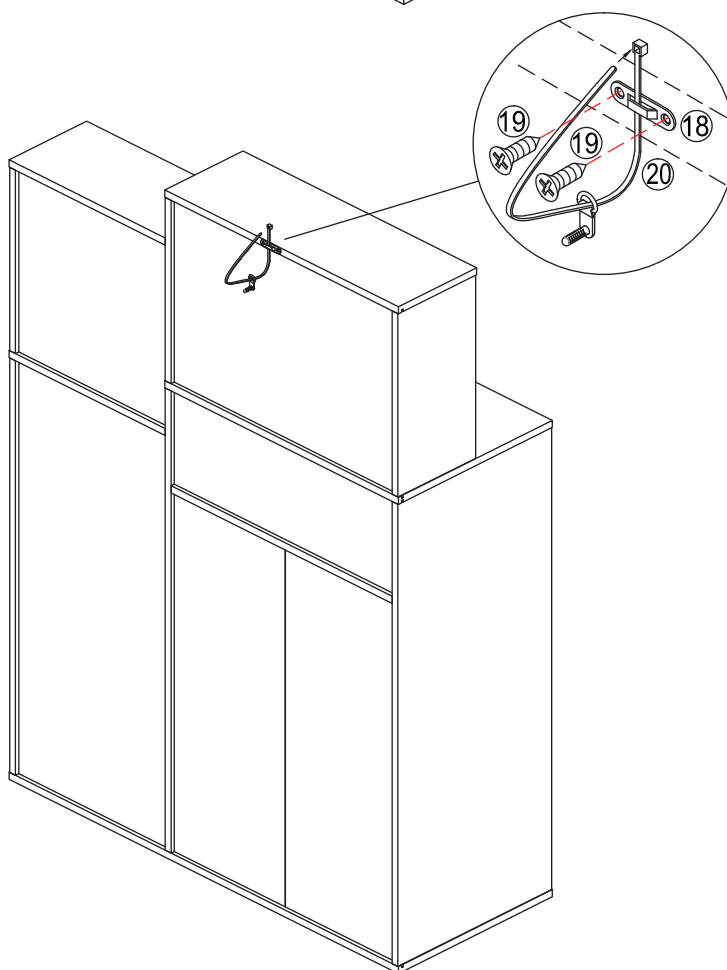
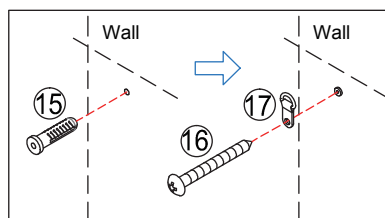

ASSEMBLY INSTRUCTIONS

STEP : 25

ASSEMBLY COMPLETED



Please ensure the furniture rests on an even and flat surface. If the product wobbles or feels loose, double-check all bolts and/or screws are properly tightened and secured.

✓ **Keep this handy!**

Please retain this instruction manual and any order-related information for future reference.

✓ **Lift, don't drag!**

To avoid damage to product please always LIFT the product when transporting or adjusting the placement.

